



schleich[®]

42614



10161359

42614



10162394 x 1



10160797 x 1



10160798 x 1



10160796 x 1



10156683 x 1



10157910 x 1



10160795 x 1



10160805 x 1



10160799 x 1



10119026 x 1



10160814 x 1



10160815 x 1



10160803 x 1



10160812 x 1



10160800 x 1



10160801 x 1



10160802 x 1



10160818 x 1



10160819 x 1



10160820 x 1



10162988 x 1



10160823 x 1



10160825 x 1



10160824 x 1



10160582 x 1

42614



10156717 x 1



10156718 x 1



10156719 x 1



10156720 x 1



10156721 x 1



10158092 x 1



10160804 x 1



10117366 x 1



10117365 x 1



10160811 x 1



10160813 x 1



10158120 x 1



10160808 x 1



10160809 x 1



10160810 x 1



10160806 x 1



10160817 x 1



10128077 x 1



10160513 x 1



10160514 x 1



10160816 x 1



10160589 x 1



10160590 x 1



10160585 x 1



10160587 x 1



10160099 x 1



10160826 x 1



10161358 x 1



10134450 x 1



10156973 x 1

1

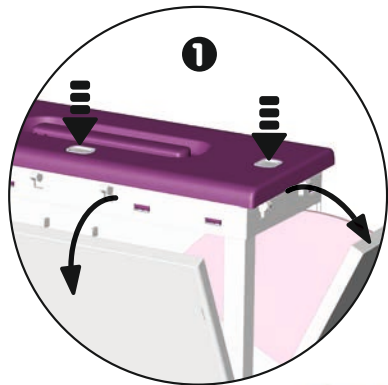

10162394



10160514

2

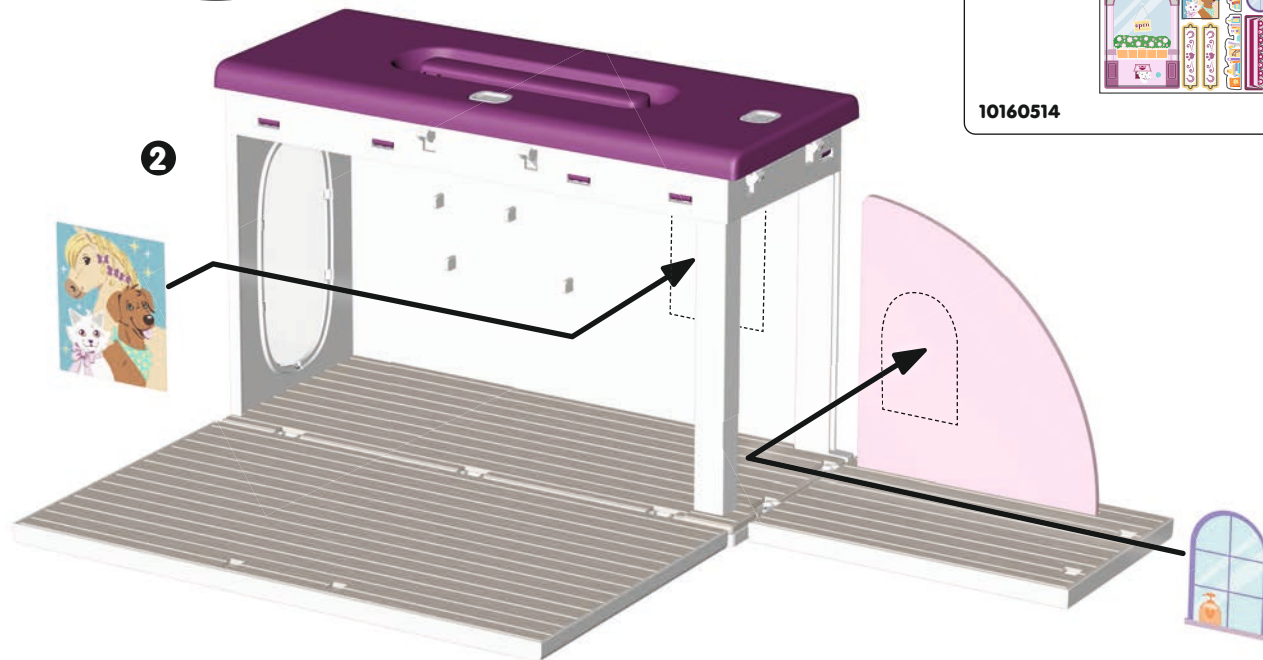

2

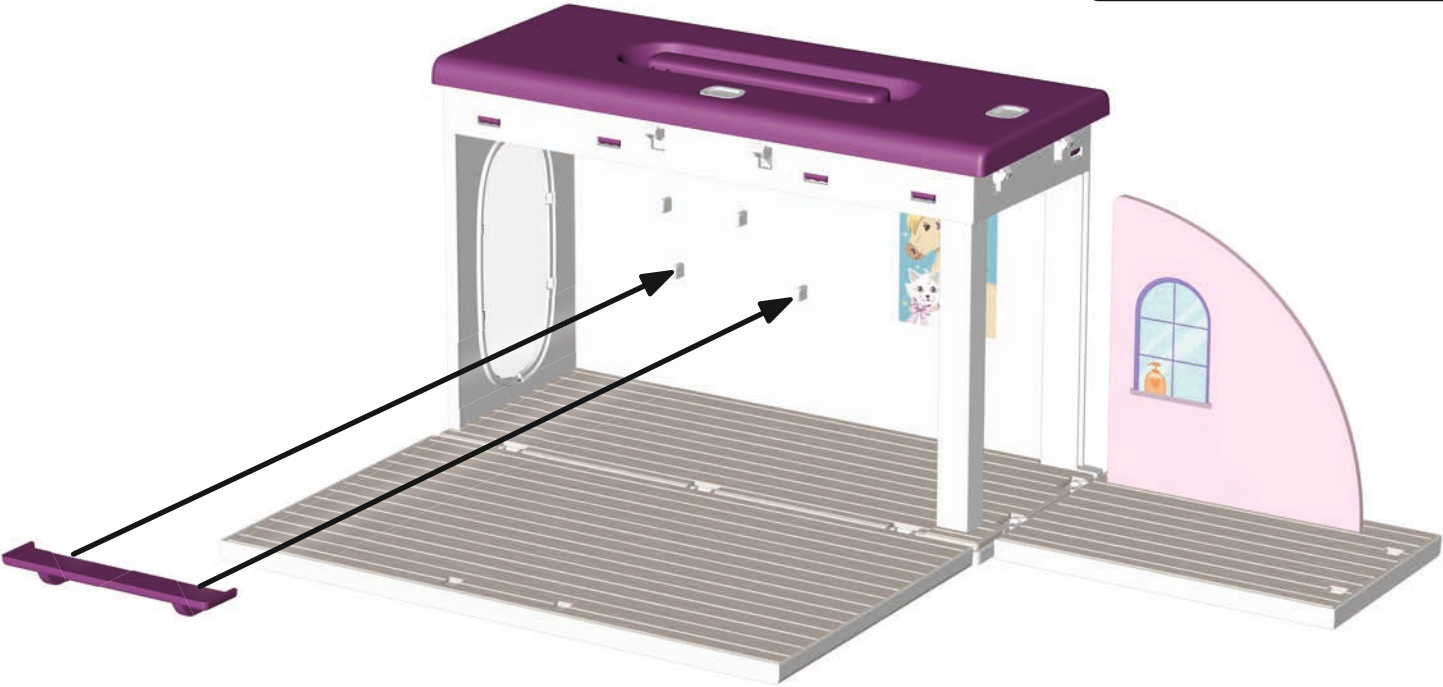

3



4



5



6



7

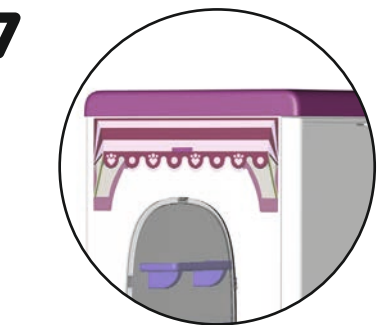

10160514

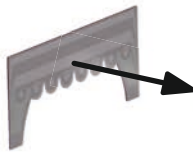

8



10160513

9



10

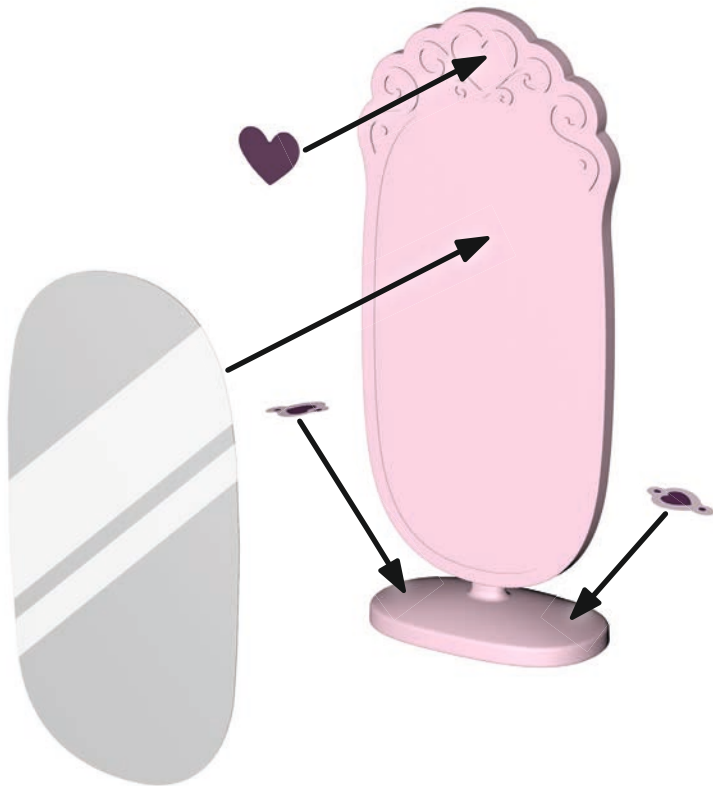

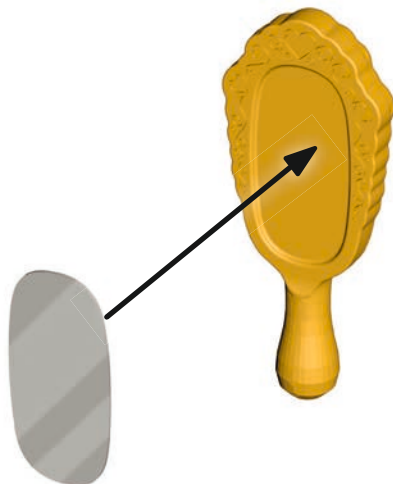

10160812



10160514

12

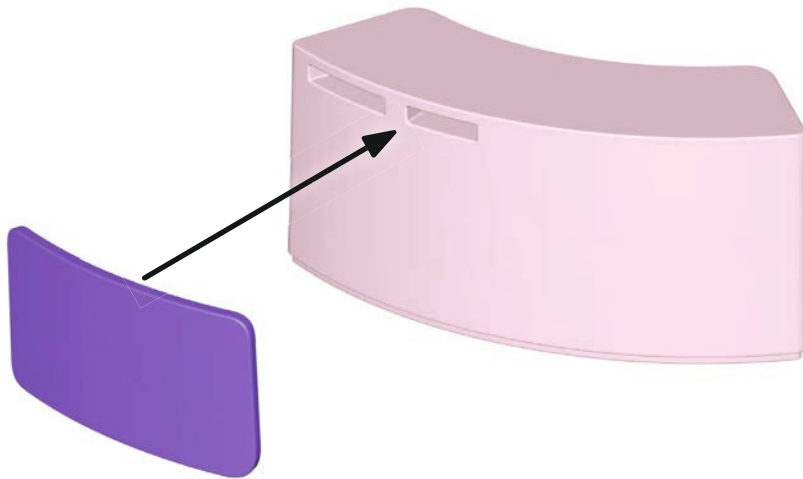

10160796



10156683

13

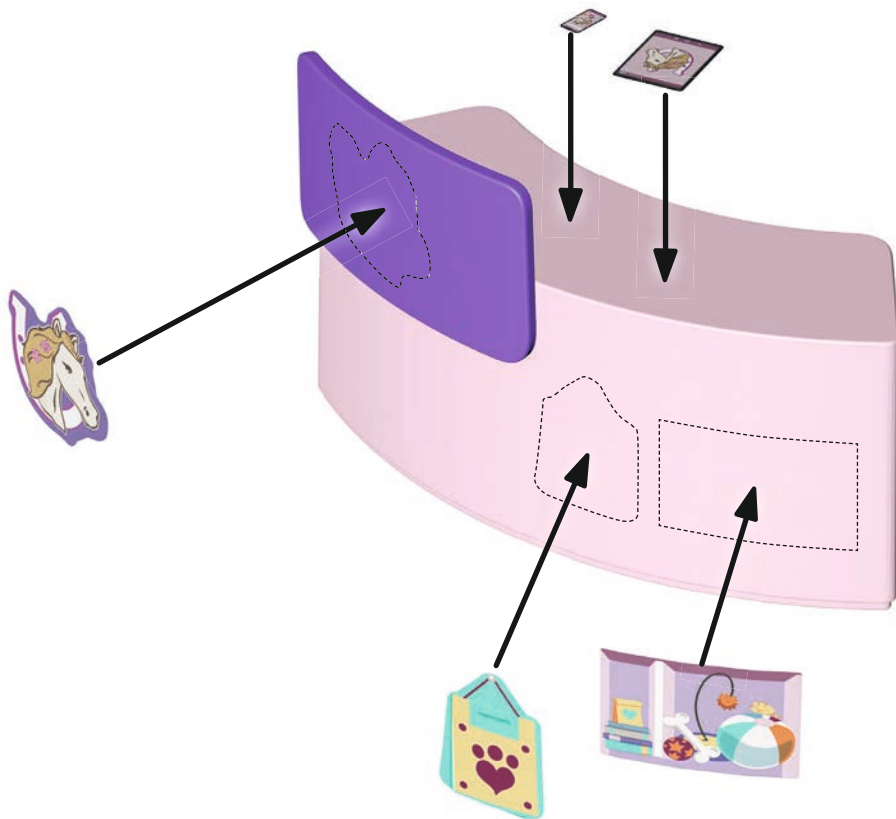

14

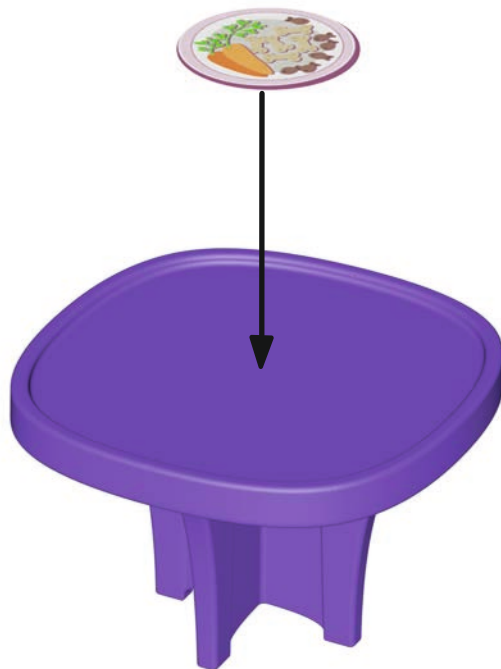

15

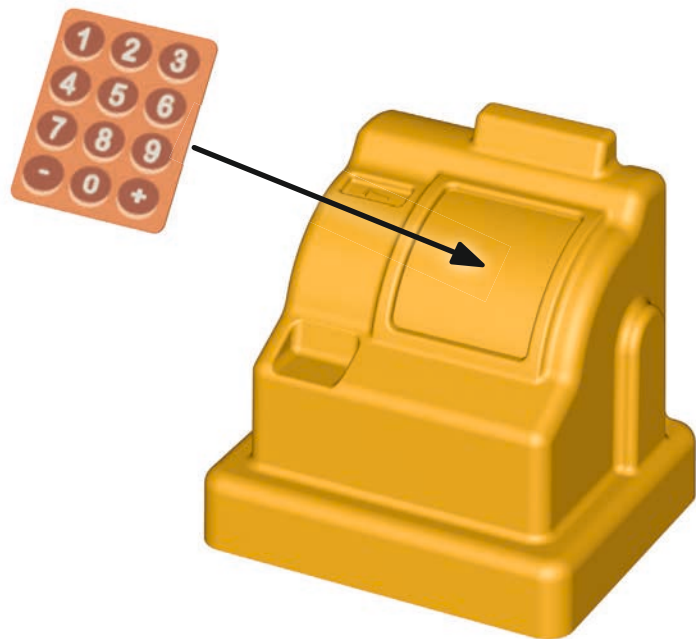

10160803



10160514

16



17

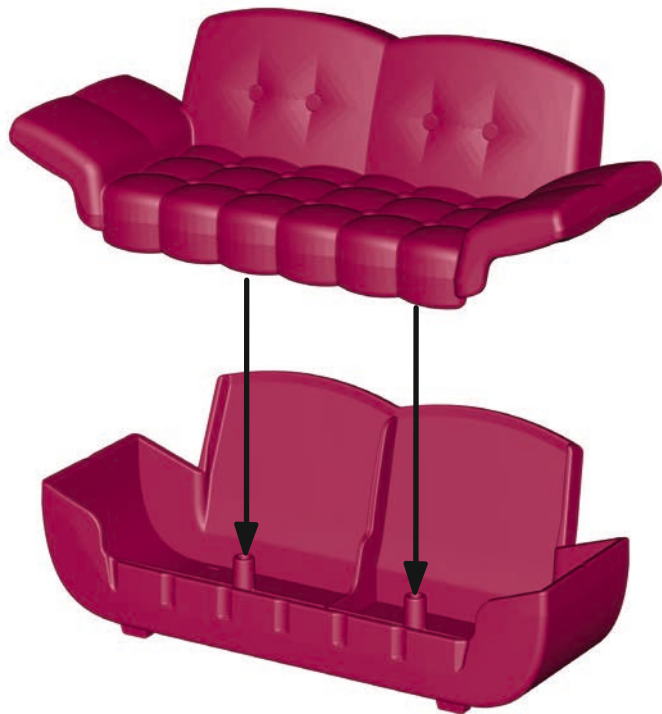

18

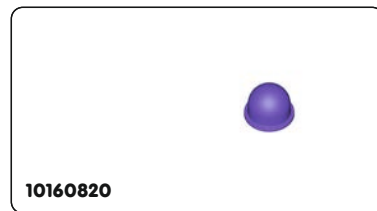
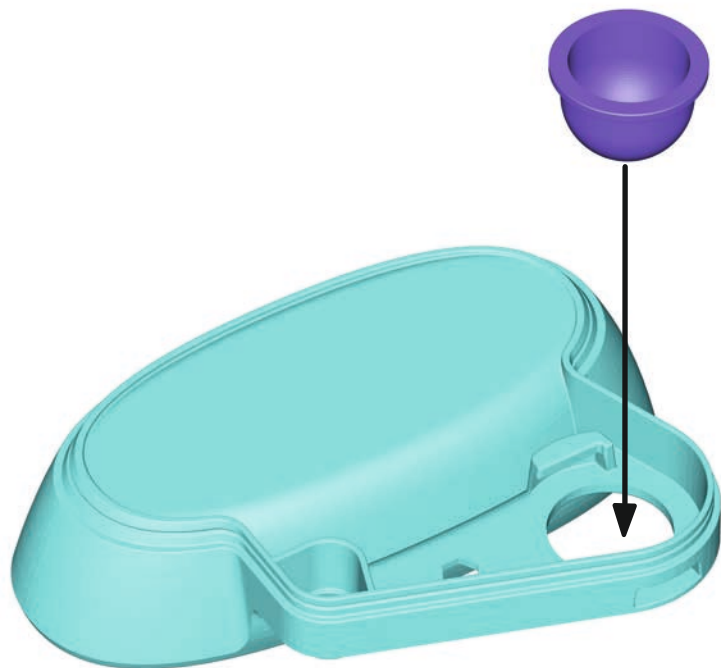

19

1

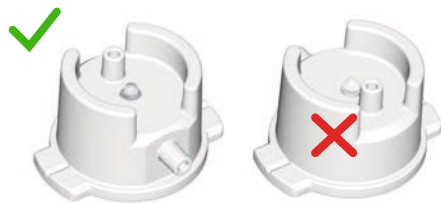

2



X

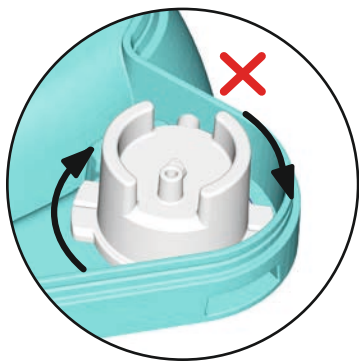

20

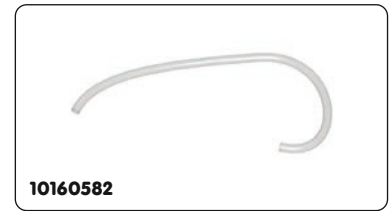
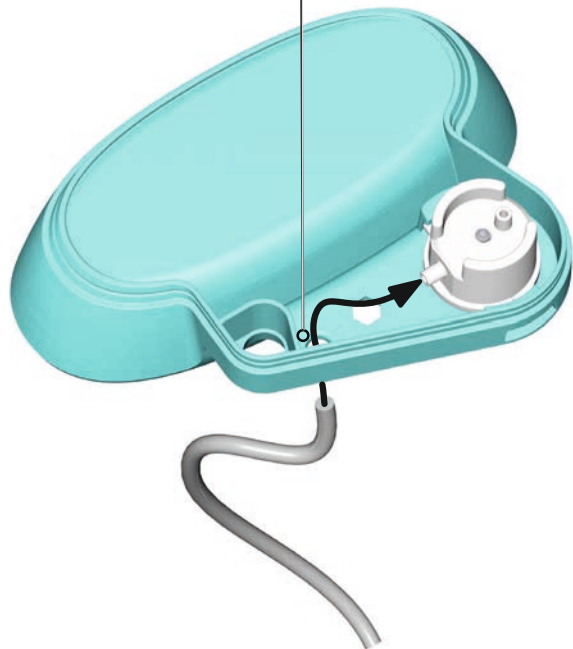
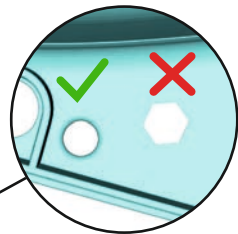

21

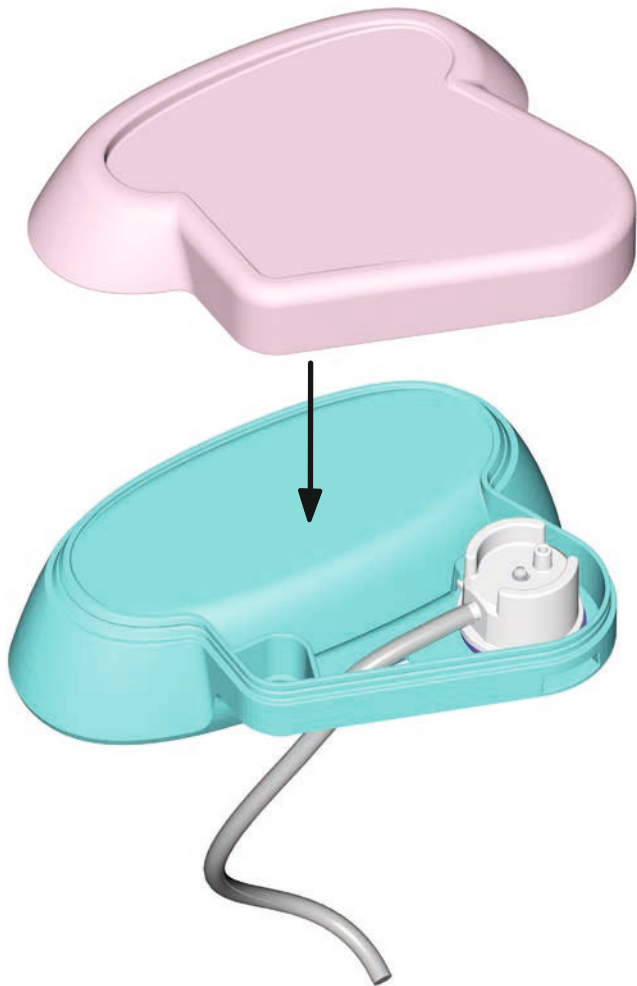

click

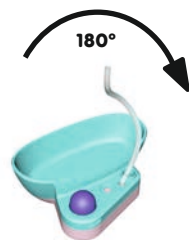

22

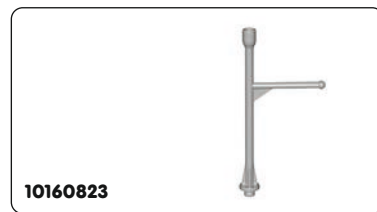
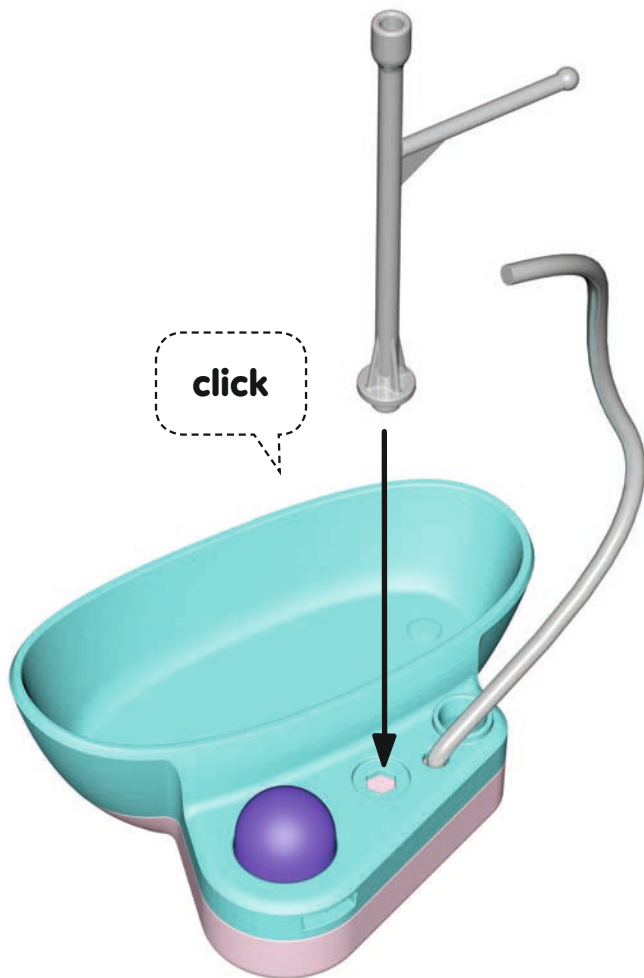

23

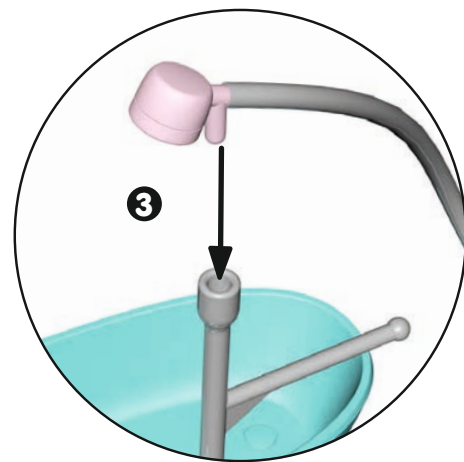
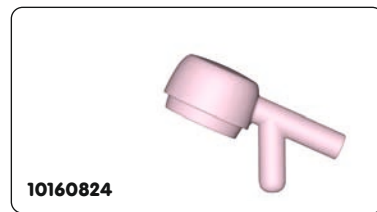
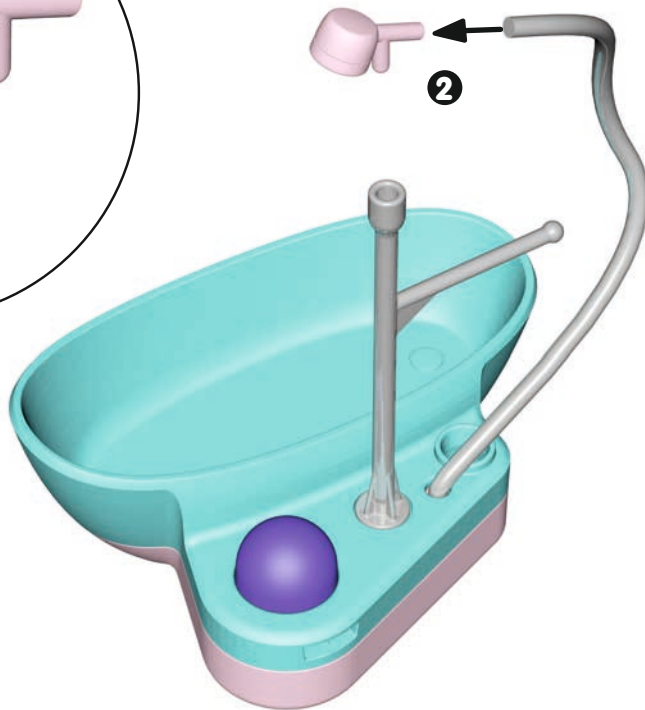
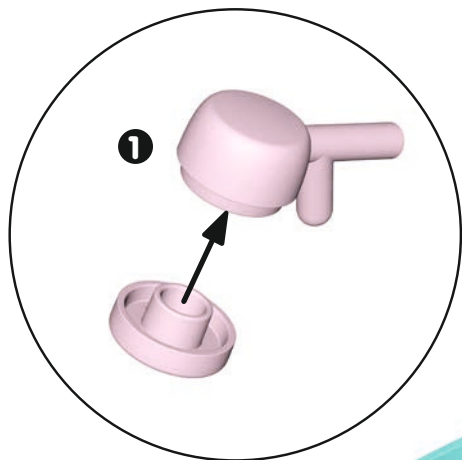

24

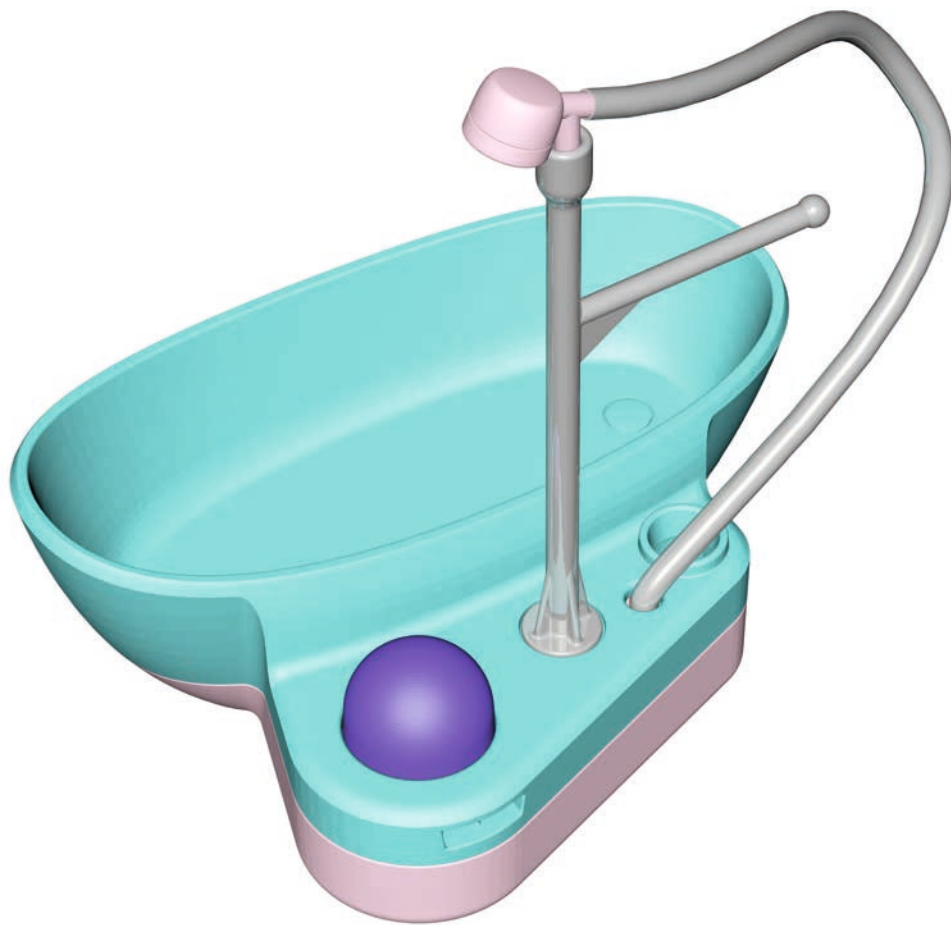

25

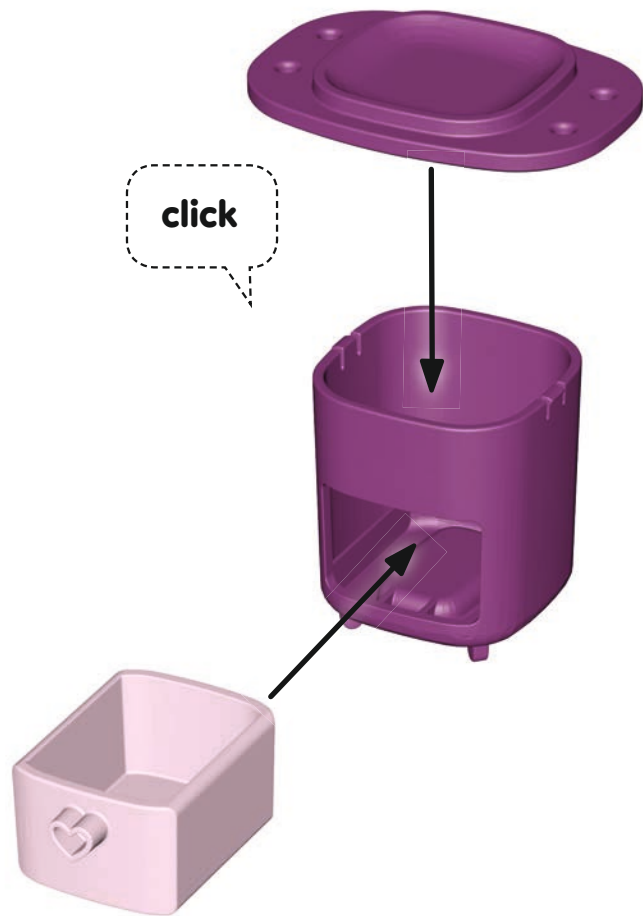

26



27

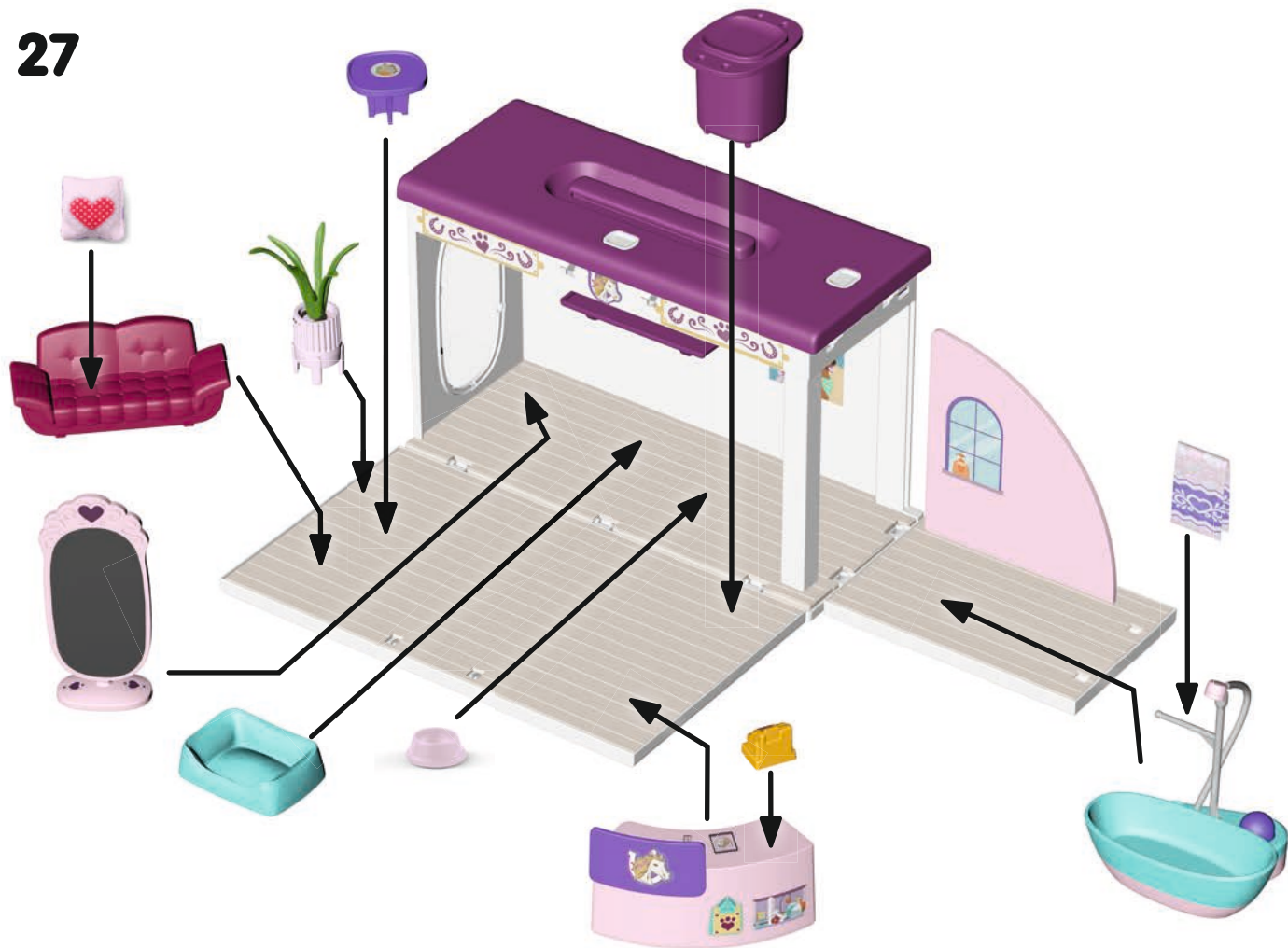

28



29

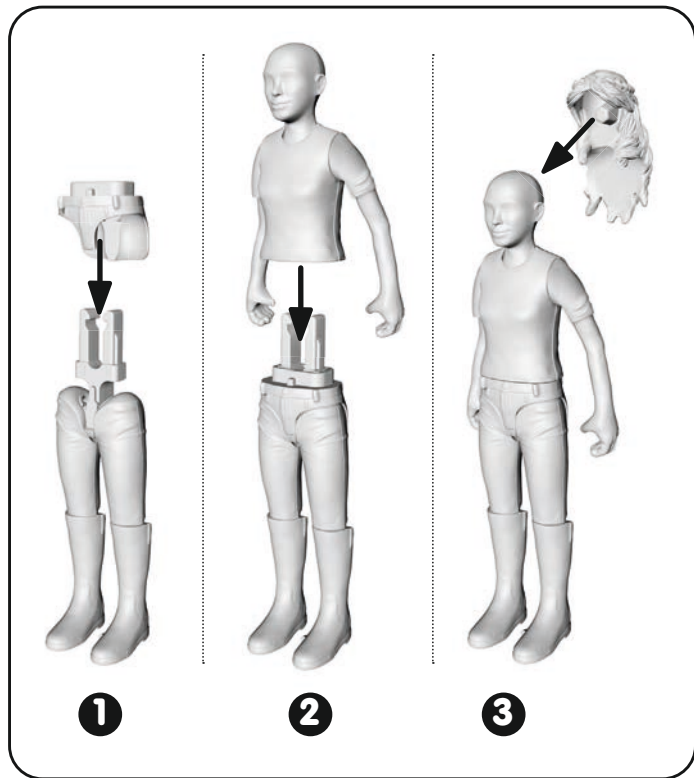

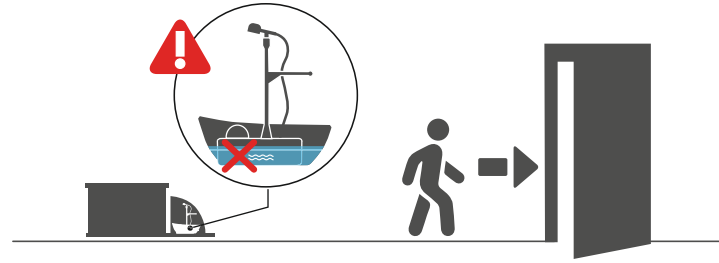
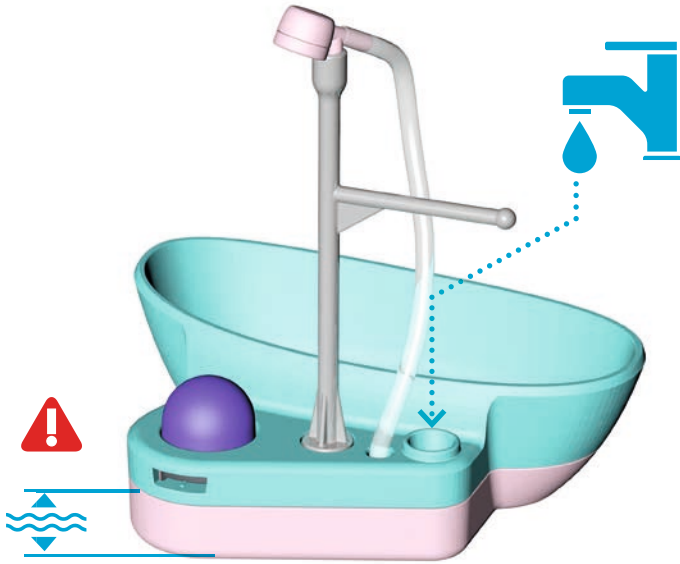





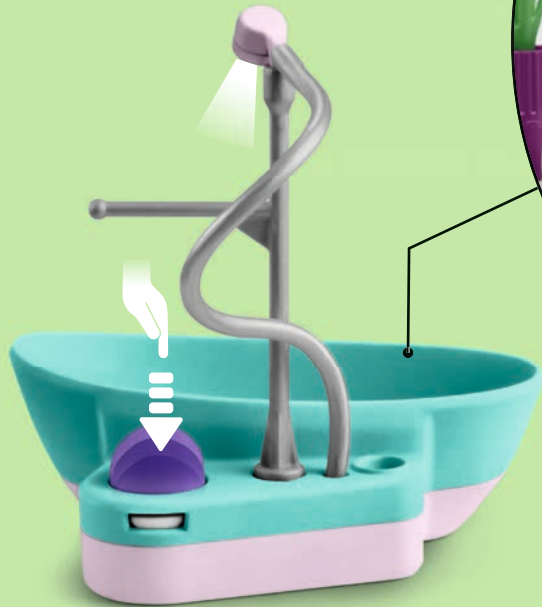





DE/AT/CH:

Farbe lässt sich von fast allen Textilien rückstandslos mit kaltem Wasser oder einer milden Seifenlauge und anschließender Waschmaschinen Wasche entfernen. Bei manchen außergewöhnlichen Materialien kann es zu Verfärbungen kommen, dies ist jedoch die Ausnahme. Trotzdem empfehlen wir während des Gebrauchs Kleidung und Möbel zu schützen.

GB/US:

Paint can be removed from almost all textiles without residue with cold water or a mild soapy water and subsequent washing machine wash. Discoloration may occur on some unusual materials, but this is the exception. Nevertheless, we recommend protecting clothing and furniture during use.

FR/BE/CH:

La peinture s'enlève sans laisser de traces sur presque tous les textiles à l'aide d'eau froide ou d'une solution savonneuse douce, suivie d'un lavage en machine. Des décolorations peuvent apparaître sur certains matériaux exceptionnels, mais cela reste l'exception. Nous recommandons néanmoins de protéger les vêtements et les meubles pendant l'utilisation.

ES:

La pintura puede eliminarse de casi todos los tejidos sin dejar residuos utilizando agua fría o una solución jabonosa suave y lavando posteriormente a máquina. Puede producirse una decoloración en algunos materiales inusuales, pero esto es la excepción. No obstante, se recomienda proteger la ropa y los muebles durante su uso.

IT/CH:

La vernice può essere rimossa da quasi tutti i tessuti senza lasciare residui utilizzando acqua fredda o una soluzione saponosa delicata seguita da un lavaggio in lavatrice. Su alcuni materiali insoliti può verificarsi una decolorazione, ma si tratta di un'eccezione. Tuttavia, si consiglia di proteggere gli indumenti e i mobili durante l'uso.

NL:

Verf kan van bijna alle textiel worden verwijderd zonder resten achter te laten met koud water of een mild sopje, gevolgd door wassen in de wasmachine. Verkleuring kan voorkomen op sommige ongebruikelijke materialen, maar dit is de uitzondering. Toch raden wij aan kleding en meubilair tijdens het gebruik te beschermen.



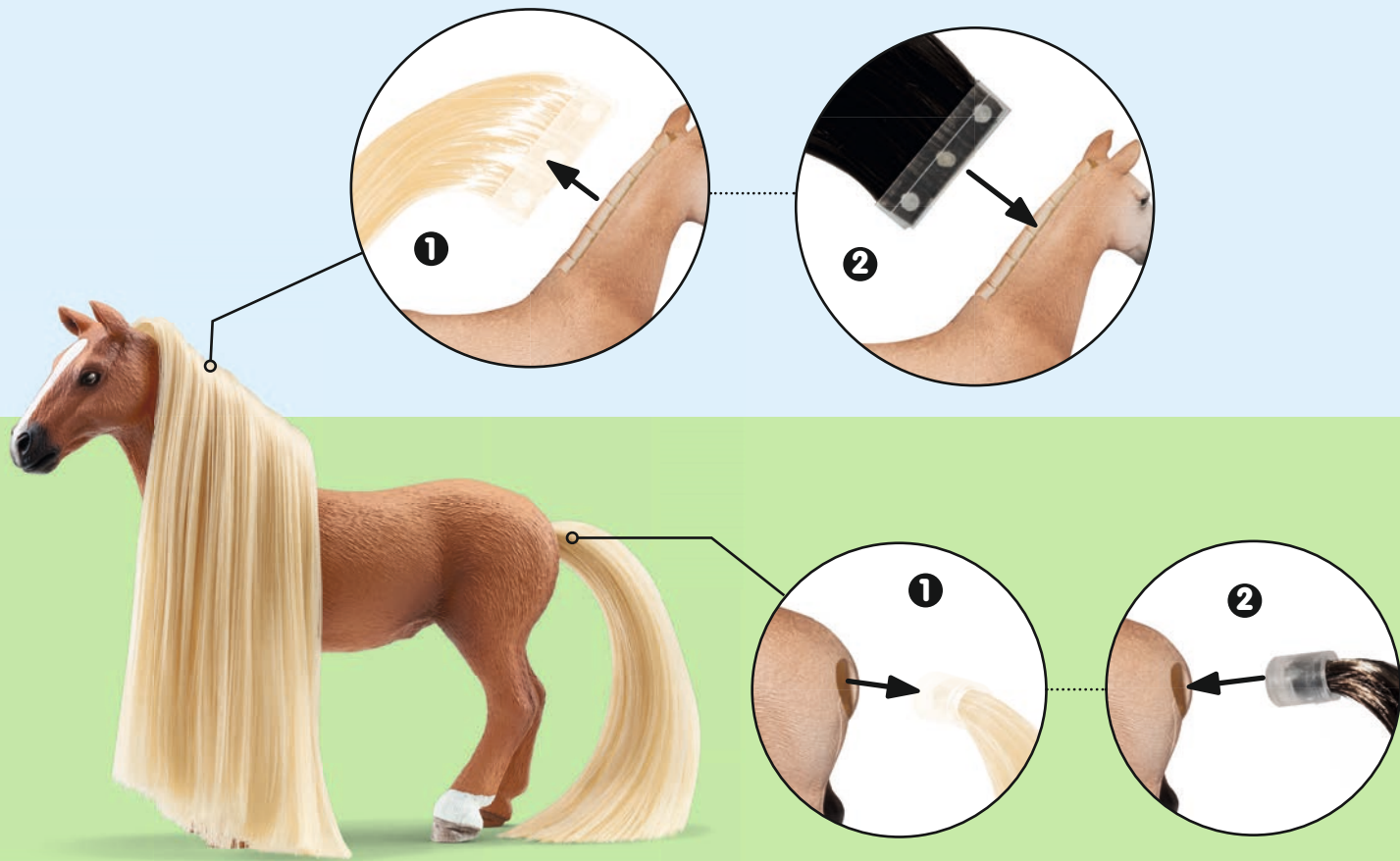

42588



42580



42584



www.schleich-s.com/stories



Photo by Mitchel Wu



Addison, 12



Mandi, 11



Rosa, 9



YouTube